

## The 6 easy steps to site assembled Armorflex...

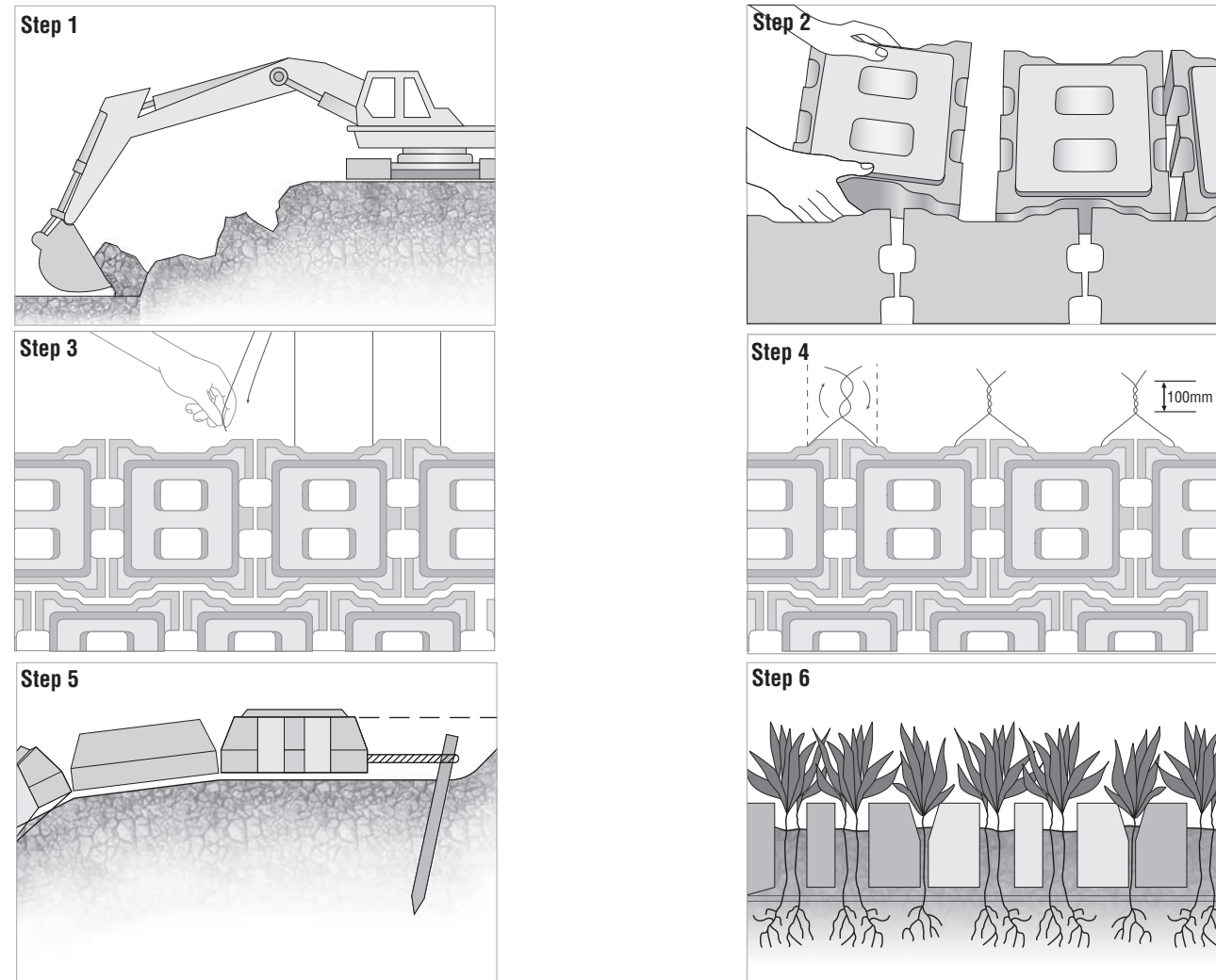

**Step 1: Site preparation, excavation, trimming & compaction**  
Prior to laying Armorflex, the base material must be profiled to line and level and should be compacted to a firm and even finish. Obstructions, such as roots and projecting stones should be removed as the quality of the preparation will be reflected in the finished surface. The angle of repose of the in situ material must not be exceeded. Maximum desired slope is 1:1,5

**Step 2: Handling & placing by manual labour**  
Armorflex loose block should be placed in a stretcher bond pattern to achieve the mechanical interlock. At areas such as culvert inlets and outlets, the blocks should be placed to allow for access to the cable ducts.

**Step 3: Wiring up in situ**  
The wire is easily pushed through the cable ducts in the blocks and secured as detailed in Step 4. The choice of wire will depend on the application. A 3,1 mm diameter galvanized fencing wire or

a 5 mm diameter polyester rope can be used. In certain situations wiring up may not be necessary. Generally the wire will be threaded perpendicular to the flow.

**Step 4: A final twist to the wire**  
Galvanized wire can be twisted across the block joint for a length of minimum 100mm or a suitable knot used on the polyester cable.

**Step 5: Anchorage**  
Armorflex placed on steep slopes may slide on the geotextile until the system has settled. Temporary or permanent anchorage can be achieved with steel or wooden pegs through the top cable loops.

**Step 6: Finishing**  
Armorflex subject to wave attack should be blinded with a sand/gravel mixture. Above normal waterline, the voids should be soiled and seeded to develop natural vegetation.

Technicrete reserves the right to change or amend the contents of this document at anytime without any notice with this document intended for general information only. Any specific information required about product specifications, applications, technical information, sales conditions, warranties and guarantees as required for any design or installation should be obtained from Technicrete.

## TECHNICRETE Armorflex®

The engineered solution for simple erosion protection

Technicrete Armorflex® erosion control system provides an alternative for a wide variety of erosion control and drainage projects. Technicrete Armorflex® system is flexible, conforming to ground contours, settling without cracking, and requires limited ground preparation.

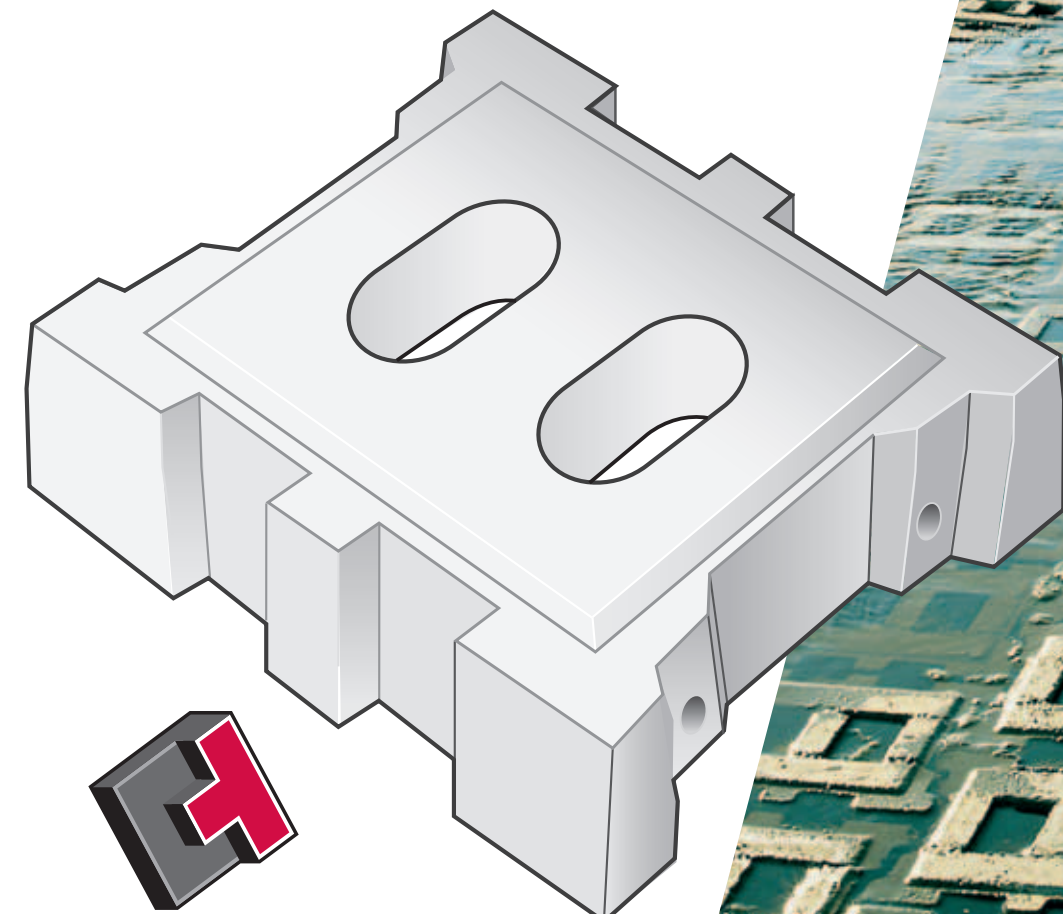

TECHNICRETE  
quality support

CONCRETE ROOF TILES • EROSION PROTECTION BLOCKS • KERBS • MASONRY • PAVING • PREBAGGED PRODUCTS • RETAINING WALLS • SLOPE SUPPORT SYSTEMS



**Technicrete House**  
Cnr. Main Reef Road & Houtkapper Street, Roodepoort, 1725  
Tel: 011 674 6900 – Fax: 011 672 1425  
Email: info@technicrete.co.za  
www.technicrete.co.za  
0861 266267



**Branches:**  
Carletonville: 018 790-4380  
Evander: 017 689-2100  
Stilfontein: 018 484-6234

**White River:** 013 758-1203  
**Olifantsfontein:** 011 203-7700  
**Polokwane:** 015 298-8083  
**Welkom:** 057 391-4200  
**Witbank:** 013 696-1153

**BCT Rustenburg:** 014 538-0818  
**Port Elizabeth:** 041 372 2230